

# BVM C SAFETY CLAMP

The BVM "C" Safety Clamp is designed to handle drill collars and tubulars with flush joints or low profile shoulders. If the load is increased or the pipe is dropped the BVM web shaped dies will grip tighter. BVM "C" Safety Clamp comes in sizes to fit pipe sizes from 3 3/4" to 43". The "C" Safety Clamp is made from alloy steel, heat treated and magnetic particle inspected. All steel specifications are certified.

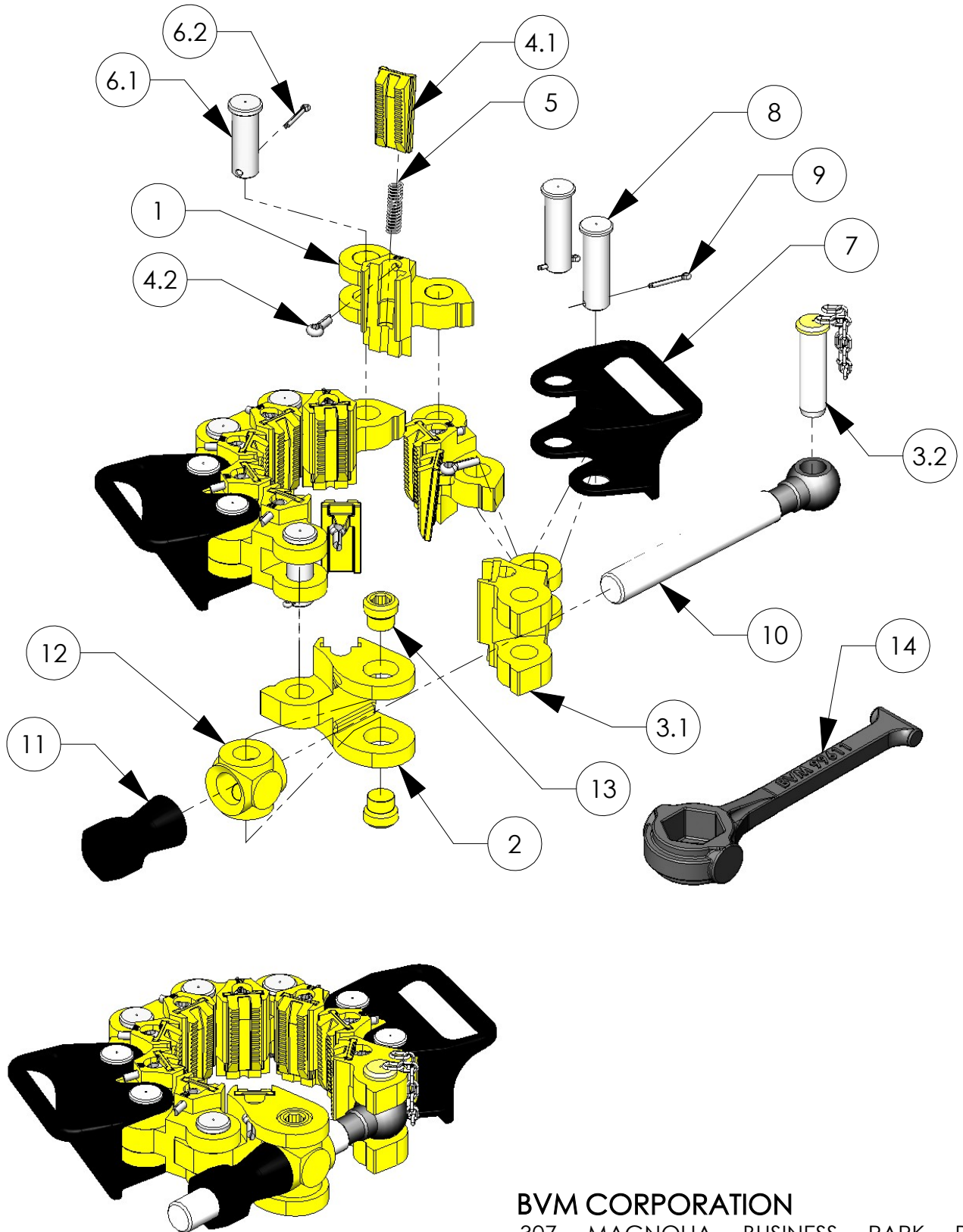

7/1/21

CS99502 SHOWN

**BVM CORPORATION**

307 MAGNOLIA BUSINESS PARK DR.  
MAGNOLIA, TX 77354; PHONE: 346-296-5501  
www.bvmcorp.com; sales@bvmcorp.com

# BVM C SAFETY CLAMP

## Replacement parts

ITEM NO.	PART NO	O.E.M. P/N	CS & CM QTY	CL QTY	DESCRIPTION	WEIGHT
--	99613	7624-A-7	--	--	COMPLETE LINK ASSEMBLY (ITEMS 1, 4, 5, & 6)	--
1	99601	7624-A-1	AR	AR	CENTER LINK	3.4
2	99600	7624-A-24	1	2	END LINK PIVOT BLOCK	4.1
3	99620	--	1	2	END LINK & PIN ASSEMBLY	5.4
3.1	99602	7624-A-3	--	--	END LINK	4.4
3.2	99610-1	--	--	--	END LINK PIN	0.9
3.3	99610-2	--	--	--	CHAIN	--
4	99608-1	7624-A-1	AR	AR	INSERT w/COTTER PIN	--
4.1	99608	--	1/Item 4	1/Item 4	INSERT	0.5
4.2	30030-06-0	900620-65	1/Item 4	1/Item 4	COTTER PIN	0.1
5	99609	7624-E-5	AR	AR	INSERT SPRING	--
6	99607	--	AR	AR	INTERMEDIATE LINK PIN w/COTTER PIN	--
6.1	99607-1	7624-C-5	1/Item 6	1/Item 6	INTERMEDIATE LINK PIN	0.7
6.2	30030-10-0	900620-38	1/Item 6	1/Item 6	COTTER PIN	0.1
7	99603	7624-5138	2	4	HANDLE	4.3
8	99617	--	4	8	HANDLE LINK PIN	0.9
9	30030-10-0	900620-38	4	8	COTTER PIN	0.1
10	99604	7624-A-5	1	2	SCREW	4.0
11	99606	7624-B-5	1	2	NUT	1.6
12	99605	7624-A-5000	1	2	PIVOT BLOCK	1.4
13	99614	7624-D-5	2	4	PIVOT BLOCK SCREW	0.3
14	99611	7624-A-25	1	1	NUT WRENCH	4.7
--	99612	7624-A-9	--	--	SAFETY CLAMP BOX	45.0
--	99000-SP	--	--	--	C CLAMP SPARE PARTS KIT	--

## Safety Clamp Complete with Inserts less Box

COLLAR SIZE	BVM P/N	O.E.M. P/N	TOTAL NO. LINKS REQ. PER SIZE	WEIGHT (lbs)	
3 3/4" - 4 5/8"	CS99500	7624-5007	7	60	
4 1/2" - 5 5/8"	CS99501	7624-5008	8	66	
5 1/2" - 6 5/8"	CS99502	7624-5009	9	70	
6 1/2" - 7 5/8"	CS99503	7624-5010	10	76	
7 1/2" - 8 5/8"	CS99504	7624-5011	11	81	
8 1/2" - 9 5/8"	CS99505	7624-5012	12	86	
9 1/2" - 10 5/8"	CS99506	7624-5013	13	91	
10 1/2" - 11 5/8"	CM99507	7624-5014	14	95	
11 1/2" - 12 5/8"	CM99508	7624-5015	15	103	
12 1/2" - 13 5/8"	CM99509	7624-5016	16	108	
13 1/2" - 14 5/8"	CM99510	7624-5017	17	113	
14 1/2" - 15 5/8"	CM99511	7624-5018	18	118	
15 1/2" - 17"	CL99512	7624-5019	18	140	Double Screw
16 1/2" - 18"	CL99513	7624-5020	19	146	Double Screw
17 1/2" - 19"	CL99514	7624-5021	20	152	Double Screw
18 1/2" - 20"	CL99515	7624-5022	21	156	Double Screw
19 1/2" - 21"	CL99516	7624-5023	22	161	Double Screw
21 1/2" - 23"	CL99517	7624-5024	24	196	Double Screw
24 - 27"	CL99518	7624-5025	28	225	Double Screw
29 1/2" - 31"	CL99519	7624-5026	34	230	Double Screw
35 1/2" - 37"	CL99525	--	38	234	Double Screw
41 1/2" - 43"	CL99526	--	44	244	Double Screw

NOTE: When ordering, please specify the number of links desired. (Each link equals one inch).

Part Number CS99500 comes with only one handle.